



# Bellingham School District

## K-12 School Facility Master Plan

# Purposes of This Presentation

---

- **To quickly review the main points from Friday’s meeting;**
- **To add a bit more information about renovating older schools;**
- **To complete the “data gathering” tasks of ESD 112; and**
- **To provide the Task Force with some ESD “thoughts” about future directions for Bellingham Schools.**

# Review of Last Meeting

- **School facility capacity is affected by three major factors:**
  - Physical size of classrooms
  - Student-teacher ratio
  - Programs
  
- **Physical condition assessment**
  
- **Functional adequacy assessment**
  
- **Site assessment**

# Summary of Scores - Sorted

Site / Date of Original Construction	Sq. Ft.	Acres	Permanant Capacity	Current Enrollment (Fall '12)	Current Utilization	Physical Condition Score	Functional Adequacy Score	Site Condition Score	Weighted Score	
Larrabee ES	1920	18,260	1.30	153	187	122%	<b>53</b>	44	87.5	53.8
Sunnyland ES	1954	32,607	2.90	253	315	125%	52	67	95.5	60.9
Lowell ES	1914	35,427	2.20	294	243	83%	<b>62</b>	49	91.0	61.0
Happy Valley ES	1956	38,697	7.46	331	294	89%	50	75	85.5	61.1
Parkview ES	1957	33,882	4.10	322	269	84%	56	67	75.5	61.3
Columbia ES	1925	35,041	3.00	253	280	111%	<b>62</b>	67	91.5	66.5
Carl Cozier ES	1951	45,390	4.00	356	339	95%	61	73	89.5	67.5
Alderwood ES	1956	49,106	10.68	331	306	92%	64	75	75.0	68.4
Roosevelt ES	1972	50,140	14.20	434	419	97%	66	77	81.5	70.9
Silver Beach ES	1977	48,364	10.00	406	416	102%	77	84	85.5	80.0
Geneva ES	1982	52,014	8.80	459	385	84%	85	76	87.5	82.6
Northern Heights ES	2002	50,108	16.00	434	427	98%	94	96	100.0	95.2
Cordata ES	2011	54,000	20.00	475	466	98%	100	97	100.0	99.1
Wade King ES	2008	50,640	16.00	475	463	97%	100	97	100.0	99.1
Birchwood ES	1928	40,000	5.06	356	-	0%				
<b>Totals w/o Portables</b>		<b>633,676</b>	<b>125.70</b>	<b>5,332</b>	<b>4,809</b>	<b>90%</b>				
Sehome HS	1966	175,623	40.50	1,262	1,003	79%	50	68	90.0	59.4
Options High School	NA	-	2.90	-	89	NA	NA	NA	86.0	NA
District Office	1908	47,715	1.41				NA	80	99.5	NA

# Pre-1950 School – Additional Thoughts

Physical renovation of this school would not solve any functional adequacy issues.

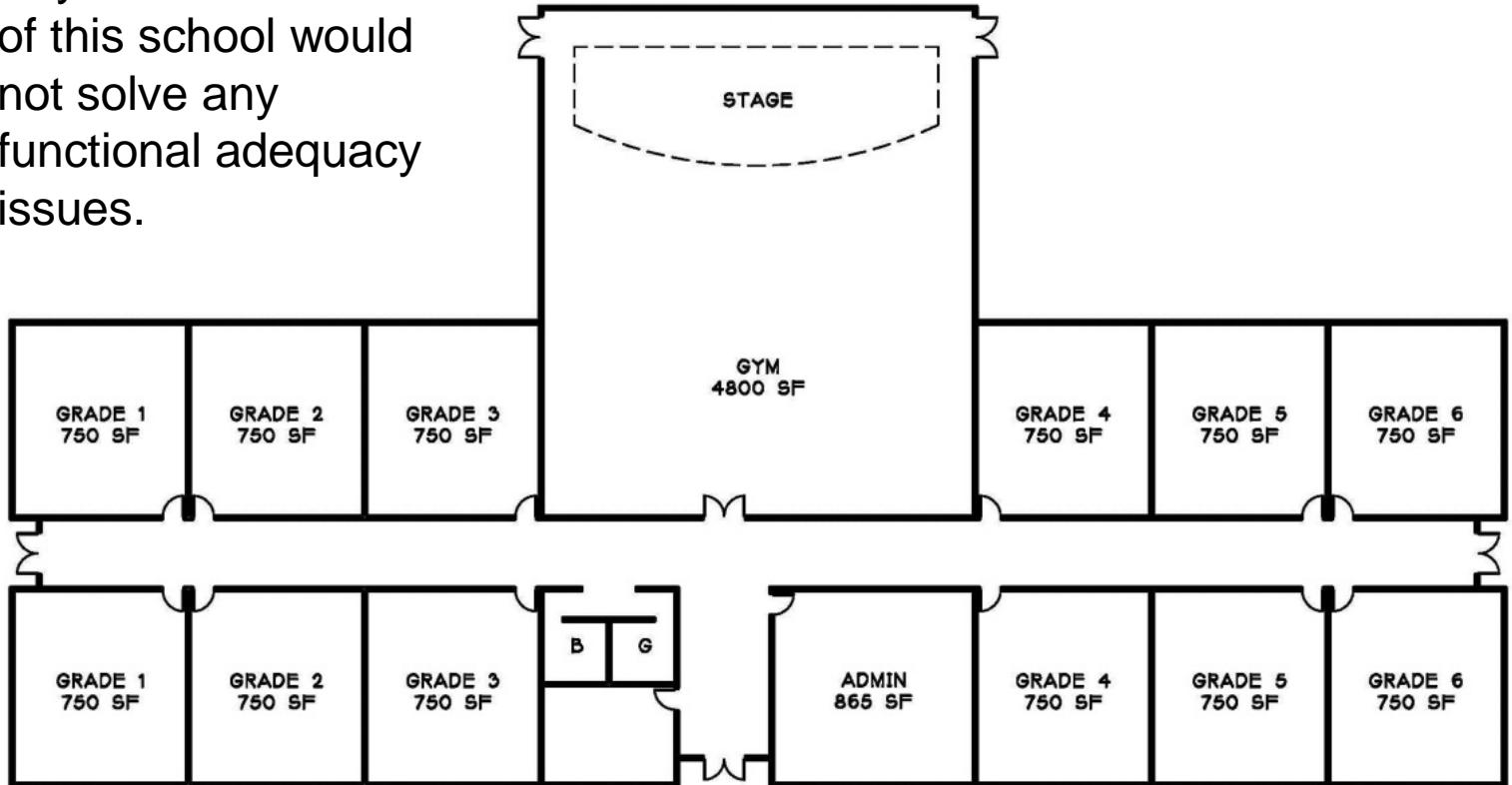

# Utilization

- Utilization is a simple arithmetic ratio of enrollment to capacity express as a percent.

$$\text{Enrollment} \div \text{Capacity} = \text{Utilization}$$

- Example:

$$3,987 \div 4,266 = 93.5\%$$

# Capacity vs. Enrollment Projection (K-5)

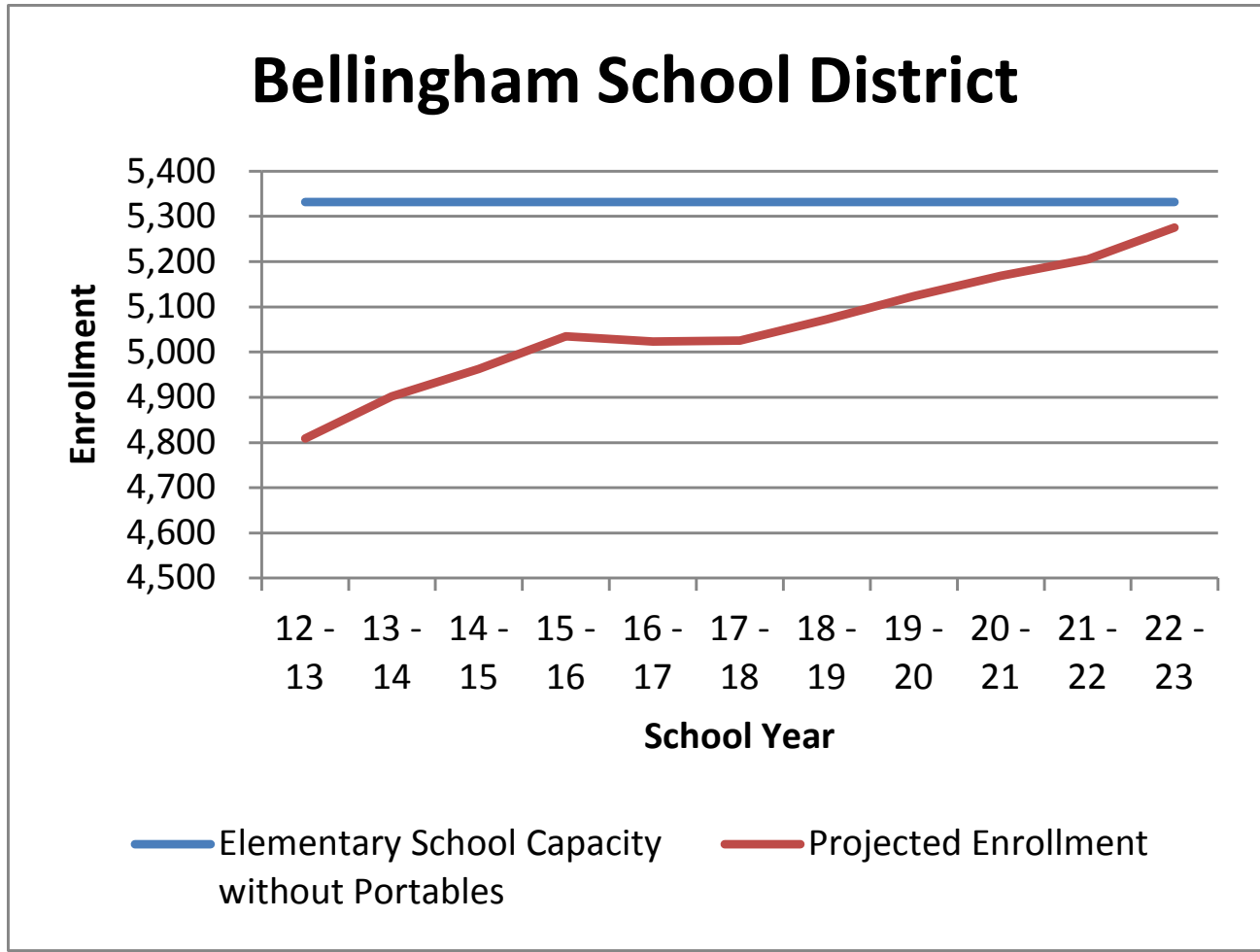

# Elem. Summary with Projection

Site / Date of Original Construction	Sq. Ft.	Acres	Permanent Capacity	Current Enrollment (Fall '12)	Current Utilization	Projected Enrollment Fall 2022	Projected Utilization Fall 2022	Physical Condition Score	Functional Adequacy Score	Site Condition Score	Weighted Score
Larrabee ES	1920	18,260	1.30	153	187	122%		53	44	87.5	53.8
Sunnyland ES	1954	32,607	2.90	253	315	125%		52	67	95.5	60.9
Lowell ES	1914	35,427	2.20	294	243	83%		62	49	91.0	61.0
Happy Valley ES	1956	38,697	7.46	331	294	89%		50	75	85.5	61.1
Parkview ES	1957	33,882	4.10	322	269	84%		56	67	75.5	61.3
Columbia ES	1925	35,041	3.00	253	280	111%		62	67	91.5	66.5
Carl Cozier ES	1951	45,390	4.00	356	339	95%		61	73	89.5	67.5
Alderwood ES	1956	49,106	10.68	331	306	92%		64	75	75.0	68.4
Roosevelt ES	1972	50,140	14.20	434	419	97%		66	77	81.5	70.9
Silver Beach ES	1977	48,364	10.00	406	416	102%		77	84	85.5	80.0
Geneva ES	1982	52,014	8.80	459	385	84%		85	76	87.5	82.6
Northern Heights ES	2002	50,108	16.00	434	427	98%		94	96	100.0	95.2
Cordata ES	2011	54,000	20.00	475	466	98%		100	97	100.0	99.1
Wade King ES	2008	50,640	16.00	475	463	97%		100	97	100.0	99.1
Birchwood ES	1928	40,000	5.06	356	-	0%					
<b>Totals w/o Portables</b>		<b>633,676</b>	<b>125.70</b>	<b>5,332</b>	<b>4,809</b>	<b>90%</b>	<b>5,275</b>	<b>99%</b>			
<b>Portable Classrooms @ 5%</b>				<b>267</b>							
<b>Elementary Grand Total with Portable Classrooms</b>				<b>5,599</b>	<b>4,809</b>	<b>86%</b>	<b>5,275</b>	<b>94%</b>			



# Findings

- **Finding A - The Bellingham School District will experience slow growth in enrollment in the next 10 years (about 1% per year).**
- **Finding B – The use of portable classrooms is giving some “wiggle room” and keeping schools from being overcrowded.**
- **Finding C – Elementary school physical condition scores ranged from poor to good (avg. = 70 - “fair”).**

# Findings (continued)

- **Finding D – Elementary school functional adequacy scores ranged from unsatisfactory to good (avg. = 75 – “fair”).**
- **Finding E – Elementary school site condition scores ranged from fair to good (avg. = 89 - “fair”).**

# ESD 112 Initial Thoughts

(Not Prioritized)

- **# 1 – Initiate a major renovation/replacement with additions to Sehome High School and provide special learning program space expansion (e.g. special education, CTE, etc.) This would address problems of capacity, physical condition, and functional adequacy.**
- **# 2 – Renovate/replace elementary school facilities, beginning with those having the lowest composite scores. (i.e. Sunnyland, Lowell, Happy Valley, Parkview, etc.) This would address problems of functional adequacy and physical condition (enhance accessibility, energy efficiency, etc.)**

## ESD 112 Initial Thoughts .... (continued)

- **# 3 – Expand the two-section schools into three-section schools where site sizes and core spaces will support additional students. (In some cases, undersized core spaces may also be expanded.) This would address problems of capacity and functional adequacy.**
- **# 4 - Due to inadequate functionality, physical condition and site size, re-purpose or close the Larrabee School and send its students to adjacent schools. This would place Larrabee students in functionally adequate buildings with adequate capacity that would be in good physical condition.**

## ESD 112 Initial Thoughts .... (continued)

- **# 5 – Schools with overall higher scores may have building components (roof, plumbing, electrical, etc.) with individual low scores. Plan for improvement projects to address those individual low scores in those cases. This would address problems of physical condition.**
- **# 6 – Due to inadequate functionality, physical condition and site size, relocate or build a new Options High School and increase its capacity to approximately 250. This would address problems of capacity, physical condition, and functional adequacy. (Multiple options)**

## ESD 112 Initial Thoughts .... (continued)

---

- **# 7 - Due to inadequate functionality, physical condition and site size, the Bellingham School District should relocate or rebuild the District Office. The District should seek a site with improved parking, a facility that is functionally adequate, and a building that is in good physical condition. (Multiple options)**

---

**Now.....**

**Your Thoughts, Discussion,  
Questions, and Answers**

A decorative graphic on the left side of the slide consisting of three vertical bars: a black bar on the far left, a brown bar in the middle, and a light grey bar on the right. A horizontal grey bar spans the top of the slide.

**Next Steps...**